

2009 AIRFIELD CONSTRUCTION PROJECTS

MINNEAPOLIS - ST. PAUL INTERNATIONAL AIRPORT

(WOLD - CHAMBERLAIN FIELD)

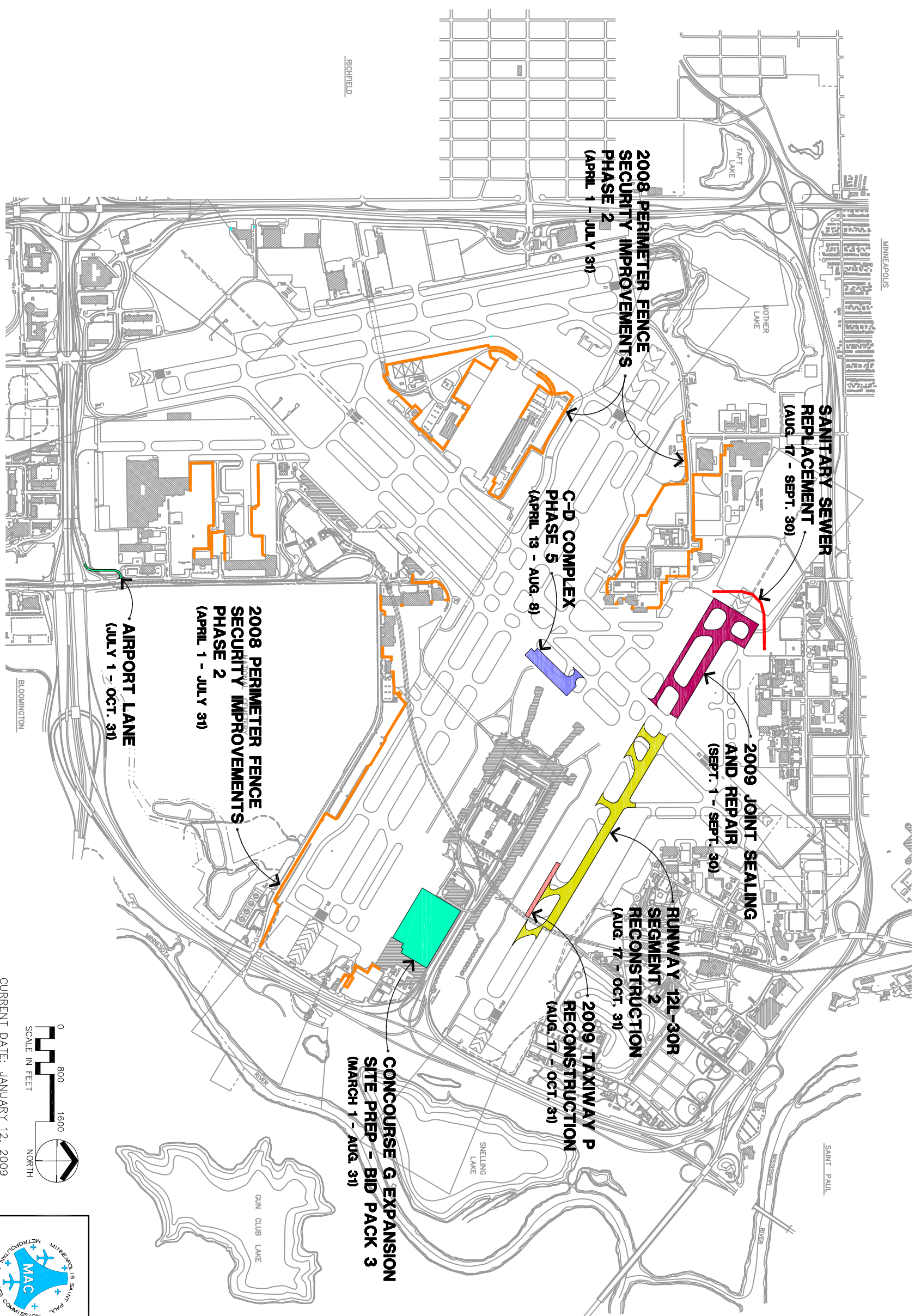

- 2009 AIRSIDE BITUMINOUS CONSTRUCTION (JULY - AUG.)
- 2009 MISCELLANEOUS CONSTRUCTION

**CONCOURSE G EXPANSION
SITE PREP - BID PACK 3**
(MARCH 1 - AUG. 31)

**2009 TAXIWAY P
RECONSTRUCTION**
(AUG. 17 - OCT. 31)

**RUNWAY 12L-30R
SEGMENT 2
RECONSTRUCTION**
(AUG. 17 - OCT. 31)

**2009 JOINT SEALING
AND REPAIR**
(SEPT. 1 - SEPT. 30)

**C-D COMPLEX
PHASE 5**
(APRIL 19 - AUG. 8)

**SANITARY SEWER
REPLACEMENT**
(AUG. 17 - SEPT. 30)

**2008 PERIMETER FENCE
SECURITY IMPROVEMENTS
PHASE 2**
(APRIL 1 - JULY 31)

**2008 PERIMETER FENCE
SECURITY IMPROVEMENTS
PHASE 2**
(APRIL 1 - JULY 31)

AIRPORT LANE
(JULY 1 - OCT. 31)

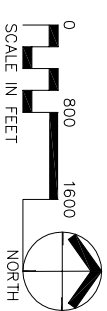

CURRENT DATE: JANUARY 12, 2009

FOR GENERAL REFERENCE ONLY
SUBJECT TO CHANGE WITHOUT NOTICE

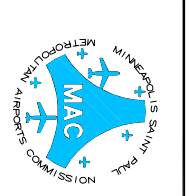

**Metropolitan
Airports
Commission**

GENERAL OFFICES
6040-28TH AVENUE SOUTH
MINNEAPOLIS, MINN. 55450